



# PROTECTOR

## SERIES



PRIVACY • SECURITY • ASSET



STRENGTH



CUSTOMER SERVICE



WORLD CLASS



## SPECIFICATIONS



SIZE 1



SIZE 2

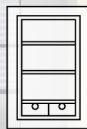

SIZE 3



SIZE 4



SIZE 5

Model	External Size H x W x D (cm)	Internal Size H x W x D (cm)	Capacity Liters	Weight +/- 10% (kg)	Active Bolts	Shelf	Drawer
1	67.7 x 58.1 x 61.4	47.7 x 38.1 x 34.0	62	405	4	1	1
2	83.0 x 65.0 x 70.4	63.0 x 45.0 x 43.0	122	590	5	1	2
3	113.0 x 65.0 x 70.4	93.0 x 45.0 x 43.0	180	755	6	2	2
4	147.0 x 74.0 x 82.3	125.0 x 52.0 x 53.0	344	1230	9	2	2
5	180.0 x 90.0 x 82.3	160.0 x 70.0 x 54.6	615	1565	10	3	2

## QUALIFICATIONS



### SSI (Structural Steel Integration)

Constructed from special thick steel, the cabinet is welded into a single piece both inside and out. This design enhances the cabinet's overall strength, making it more resistant to open and harder to destroy.



### XLarge Bolts

Oversized 38 mm bolts, more in number of bolts and rust-proofed, enhance front door security, preventing break-ins and resisting bolt cutting.



### CS350 Barrier Material

Incorporating CS350, a fireproof material, it offers 100 mm of added thickness for high heat resistance and superior penetration protection, safeguarding valuables against fire.



### Multi Protection Door

The 170 mm steel door, featuring fire-retardant and anti-drilling fill, includes 85 mm puncture-proof plates and robust hinges. With a front heat seal and fireproof backing, it offers all-around fire and theft protection, providing effective fire resistance for up to 120 minutes at an average temperature of 1015 degrees.



### S&G Combination Lock

S&G combination locks hold UL certification and offer a 3-digit code with a 1,000,000 possible combinations numbers, a combination ring to prevent code theft, and a lock that resists decryption.



### 8 Lever Key Lock

8-lever key lock, Double Bit Lock type. The key is crafted from a special metal that is strong, durable, and difficult to counterfeit.



### Automatic Relock System for Protector

The cabinet's auto-relock system, backed by safety glass and secure code, locks immediately against drilling or impact, ensuring absolute protection from unauthorized access.



### Drill Protection Alloy Steel

Strengthened with a puncture-proof steel plate made from a specially developed alloy. It protects the key code mechanism Keys and all points.



### High Quality Paint

The cabinet undergoes careful polishing and rust-proofing, with paint meticulously spray-dried in a car oven for a durable, uniform, and glossy finish.

\*Terms and conditions as designated by the company



securitysafeltd.com



+66 96 215 1234



contact@securitysafeltd.com